

Formas FormPlast

Geometrias, Composições e Dados

T1

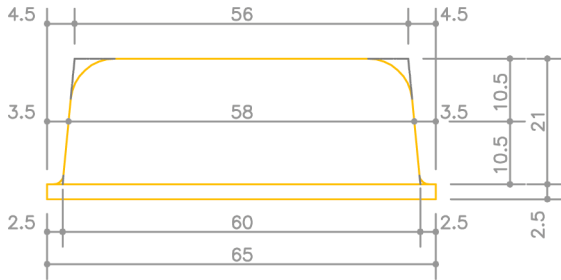

$I=18021.1\text{cm}^4 \gg Hi=14.9\text{cm}$
 $Vv=0.167\text{m}^3/\text{m}^2 \gg Hc=8.3\text{cm}$
 $\text{No.Cel./m}^2 = 2.37$
 $Vv/\text{Cel.} = 0.071\text{m}^3$

C1

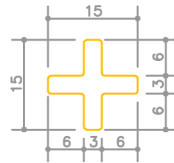

C2

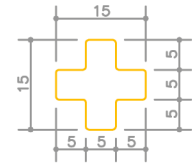

T1

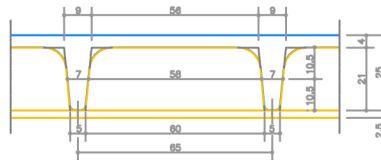

$I=18021.1\text{cm}^4 \gg Hi=14.9\text{cm}$
 $Vv=0.167\text{m}^3/\text{m}^2 \gg Hc=8.3\text{cm}$
 $\text{No.Cel./m}^2 = 2.37$
 $Vv/\text{Cel.} = 0.071\text{m}^3$

T2

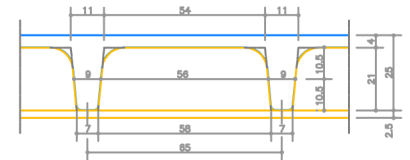

$I=22216.7\text{cm}^4 \gg Hi=16.0\text{cm}$
 $Vv=0.156\text{m}^3/\text{m}^2 \gg Hc=9.4\text{cm}$
 $\text{No.Cel./m}^2 = 2.37$
 $Vv/\text{Cel.} = 0.066\text{m}^3$

T2

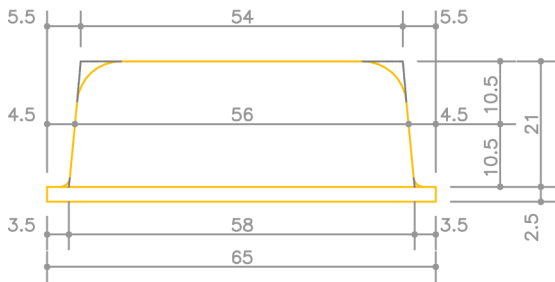

$I=22216.7\text{cm}^4 \gg Hi=16.0\text{cm}$
 $Vv=0.156\text{m}^3/\text{m}^2 \gg Hc=9.4\text{cm}$
 $\text{No.Cel./m}^2 = 2.37$
 $Vv/\text{Cel.} = 0.066\text{m}^3$

T3

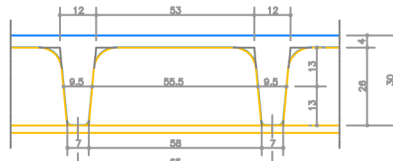

$I=38271.2\text{cm}^4 \gg Hi=19.2\text{cm}$
 $Vv=0.190\text{m}^3/\text{m}^2 \gg Hc=11.0\text{cm}$
 $\text{No.Cel./m}^2 = 2.37$
 $Vv/\text{Cel.} = 0.080\text{m}^3$

T4(T1+C2)

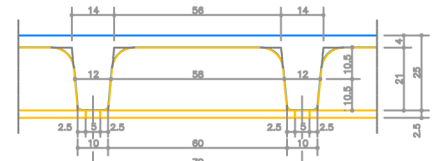

$I=28383.2\text{cm}^4 \gg Hi=16.9\text{cm}$
 $Vv=0.145\text{m}^3/\text{m}^2 \gg Hc=10.5\text{cm}$
 $\text{No.Cel./m}^2 = 2.04$
 $Vv/\text{Cel.} = 0.071\text{m}^3$

T5(T2+C1)

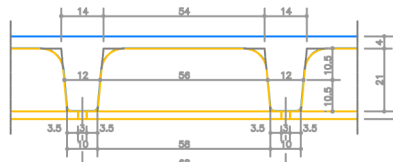

$I=28113.7\text{cm}^4 \gg Hi=17.1\text{cm}$
 $Vv=0.143\text{m}^3/\text{m}^2 \gg Hc=10.7\text{cm}$
 $\text{No.Cel./m}^2 = 2.16$
 $Vv/\text{Cel.} = 0.066\text{m}^3$

T6(T2+C2)

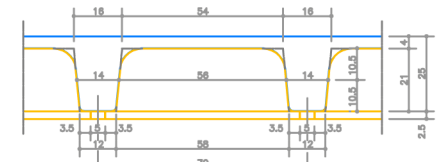

$I=31756.0\text{cm}^4 \gg Hi=17.6\text{cm}$
 $Vv=0.135\text{m}^3/\text{m}^2 \gg Hc=11.5\text{cm}$
 $\text{No.Cel./m}^2 = 2.04$
 $Vv/\text{Cel.} = 0.066\text{m}^3$

T3

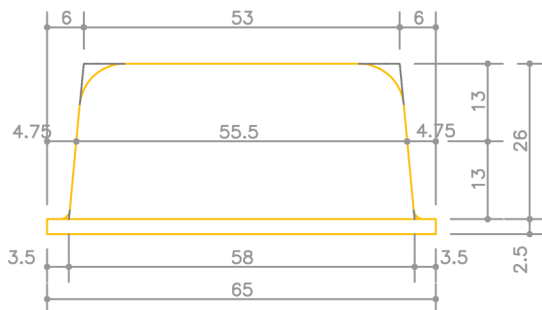

$I=38271.2\text{cm}^4 \gg Hi=19.2\text{cm}$
 $Vv=0.190\text{m}^3/\text{m}^2 \gg Hc=11.0\text{cm}$
 $\text{No.Cel./m}^2 = 2.37$
 $Vv/\text{Cel.} = 0.080\text{m}^3$

T7(T3+C1)

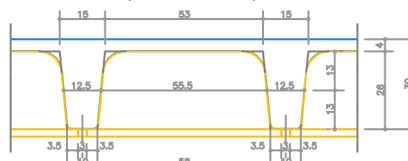

$I=48004.8\text{cm}^4 \gg Hi=20.4\text{cm}$
 $Vv=0.173\text{m}^3/\text{m}^2 \gg Hc=12.7\text{cm}$
 $\text{No.Cel./m}^2 = 2.16$
 $Vv/\text{Cel.} = 0.080\text{m}^3$

T8(T3+C2)

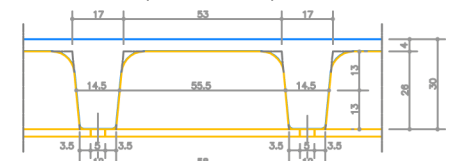

$I=54039.7\text{cm}^4 \gg Hi=21.0\text{cm}$
 $Vv=0.163\text{m}^3/\text{m}^2 \gg Hc=13.7\text{cm}$
 $\text{No.Cel./m}^2 = 2.04$
 $Vv/\text{Cel.} = 0.080\text{m}^3$